

PARTS LIST

CODE	DESCRIPTION	MATERIAL	Q.TY
Y-W0006	Upper ring washer	Plastic	1
Y-W0018	Stripper	Plastic	1
Y-W0143	ST plug	Plastic	6
Y-W0160	Skirt	Aluminium	1
Y-W0297CH	Self-tailing arm	Chromed brass	1
Y-W0302CH	Upper disk	Chromed brass	1
Y-W0721	Opening tool	S.Steel	1
Y-W1328	Upper cap	S.Steel	1
Y-WA243	Base + Gears assy	Various	1
Y-WA244	Main shaft assy	Various	1
Y-WA275	Drum	Various	1
Y-X0057	Screw	S.Steel	1

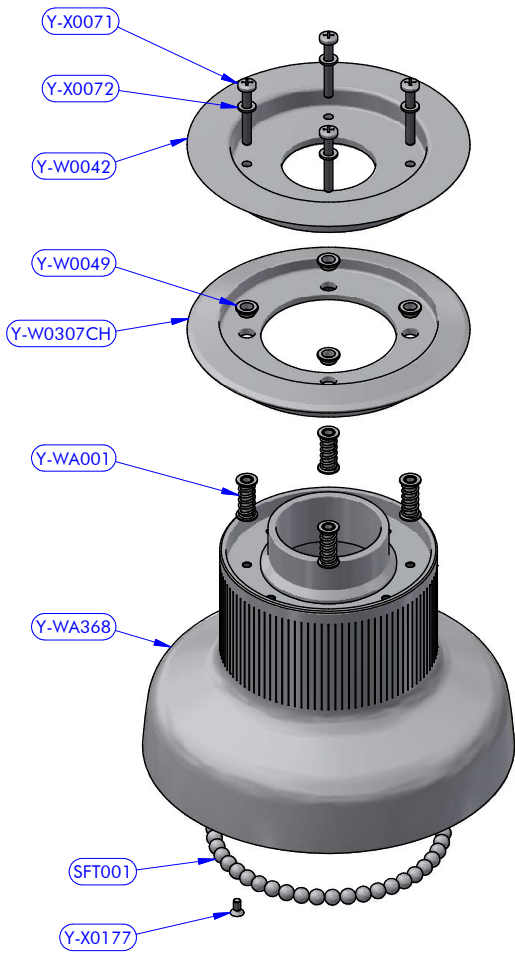

Code **Y-WA275**

Drum assy XT66 CH Z51 + ST Discs

Y-WA275 PARTS LIST			
CODE	DESCRIPTION	MATERIAL	Q.TY
SFT001	Torlon ball	Torlon	46
Y-W0042	ST central disk	Aluminium	1
Y-W0049	ST disk bush	Plastic	4
Y-W0307CH	ST lower disk	Chromed brass	1
Y-WA001	ST-spring assy	S.Steel	4
Y-WA368	Drum	Various	1
Y-X0071	Screw	S.Steel	4
Y-X0072	S.Steel washer	S.Steel	4
Y-X0177	Screw	S.Steel	1

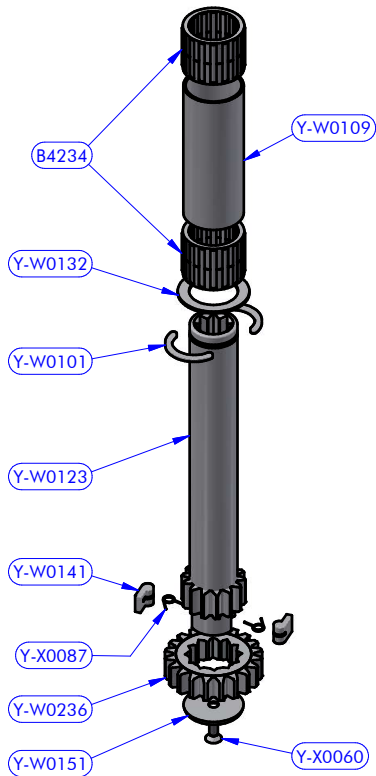

Code **Y-WA244**

Main shaft assy XT66

Y-WA244 PARTS LIST			
CODE	DESCRIPTION	MATERIAL	Q.TY
B4234	Roller bearing	Plastic / S.Steel	2
Y-W0101	Half-ring	Brass	2
Y-W0109	Pipe spacer	Plastic	1
Y-W0123	Main shaft	S.Steel	1
Y-W0132	S.Steel washer	S.Steel	1
Y-W0141	Pawl	S.Steel	2
Y-W0151	Shaft cap	Plastic	1
Y-W0236	Gear "A2"	Bronze	1
Y-X0060	Screw	S.Steel	1
Y-X0087	Torsion spring	S.Steel	2

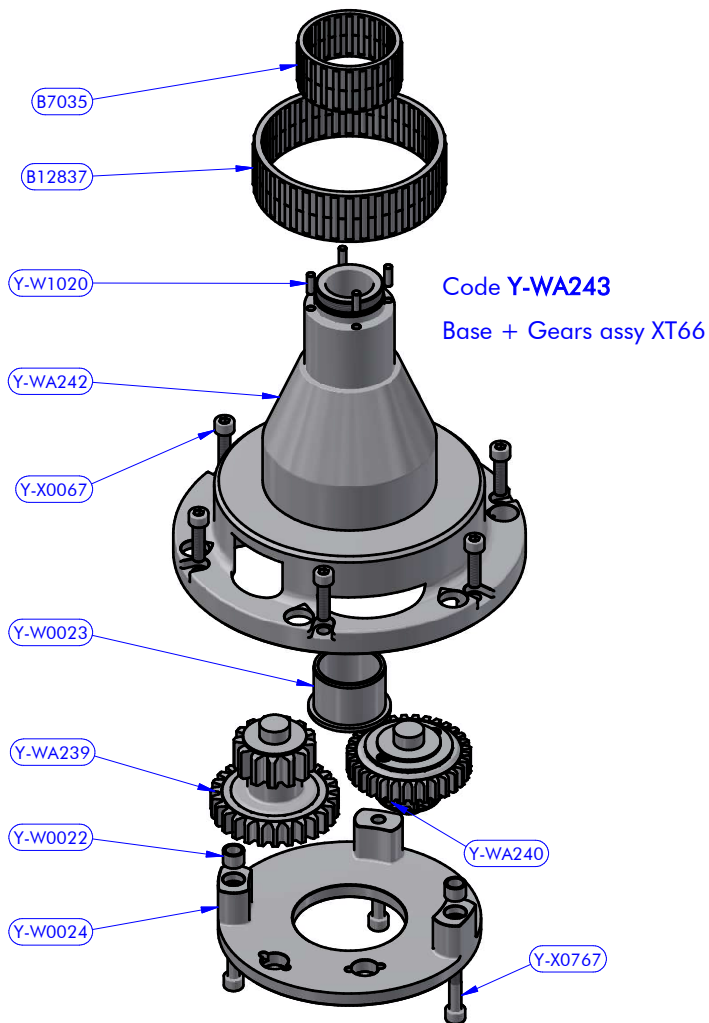

Y-WA243 PART LIST			
CODE	DESCRIPTION	MATERIAL	Q.TY
B7035	Roller bearing	Plastic / S.Steel	1
B12837	Roller bearing	Plastic / S.Steel	1
Y-W0022	Pipe spacer	S.Steel	2
Y-W0023	Bearing track	Plastic / S.Steel	1
Y-W0024	Gear base	Aluminium	1
Y-W1020	Cylinder pin	S.Steel	4
Y-WA239	Gears kit	Various	1
Y-WA240	Gears kit	Various	1
Y-WA242	Base + Stem	Various	1
Y-X0067	Screw	S.Steel	6
Y-X0767	Screw	S.Steel	3

Y-WA239 PART LIST			
CODE	DESCRIPTION	MATERIAL	Q.TY
B2519	Roller bearing	Plastic / S.Steel	3
Y-W0032	Gear ring	S.Steel	1
Y-W0053	Gear lower washer	Plastic	1
Y-W0141	Pawl	S.Steel	4
Y-W0170	Gear axis	S.Steel HR	1
Y-W0195	Gear upper washer	Plastic	1
Y-W0611	Gear "B1"	Bronze	1
Y-W0612	Gear "B2"	Bronze	1
Y-X0052	Screw	S.Steel	2
Y-X0087	Torsion spring	S.Steel	4

Y-WA240 PART LIST			
CODE	DESCRIPTION	MATERIAL	Q.TY
B2519	Roller bearing	Plastic / S.Steel	2
Y-W0032	Gear ring	S.Steel	1
Y-W0053	Gear lower washer	Plastic	1
Y-W0141	Pawl	S.Steel	4
Y-W0179	Gear axis	S.Steel HR	1
Y-W0195	Gear upper washer	Plastic	1
Y-W0239	Gear "D1"	Bronze	1
Y-W0614	Gear "D2"	Bronze	1
Y-X0052	Screw	S.Steel	2
Y-X0087	Torsion spring	S.Steel	4

